

# STUDENT INNOVATION CENTER ROOM DIRECTORY

## FOURTH FLOOR

4

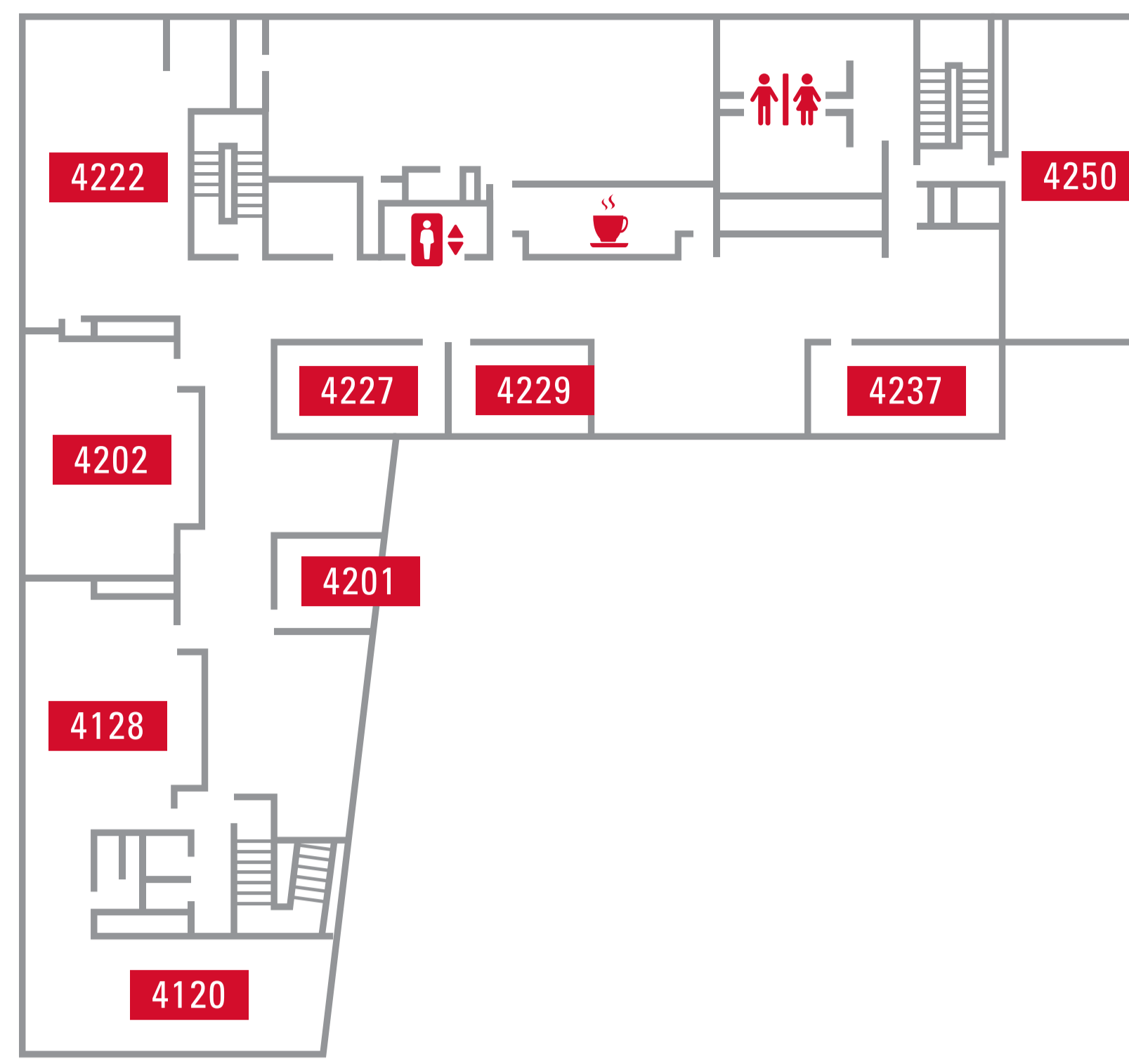

- 4120 DESIGN LAB: INSPIRE
- 4128 DESIGN LAB: CONNECT
- 4201 MEETING ROOM
- 4202 CLASSROOM
- 4222 ENGINEERING LEARNING SUITE 4222
- ELEVATORS
- SPARKS CAFÉ
- 4227 & 4229 CALS LEARNING LABS
- 4237 MEETING ROOM
- RESTROOMS
- 4250 LAUNCH PAD 4250

## THIRD FLOOR

3

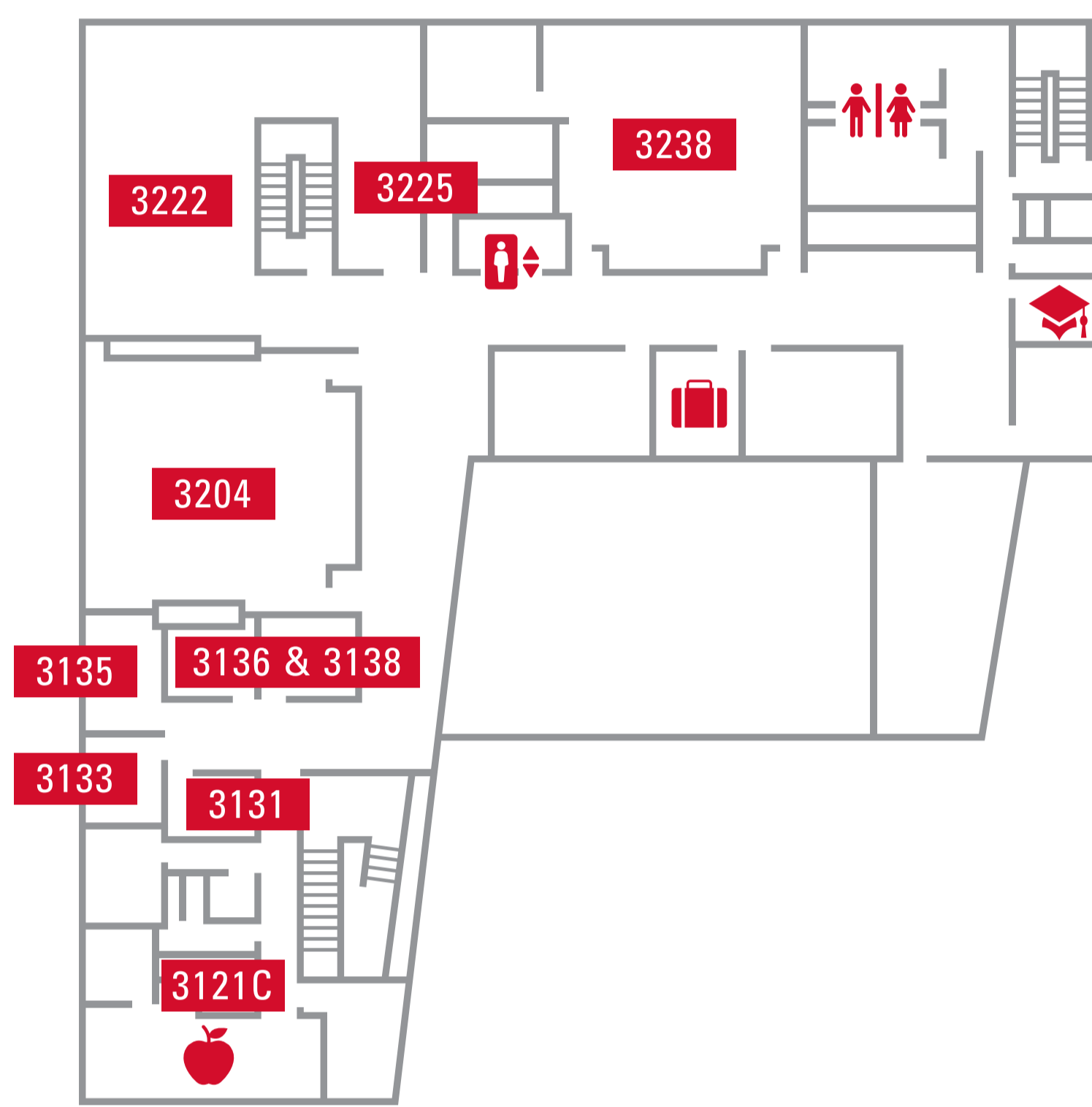

- INNOVATION PROGRAMMING SUITE
- 3121C LACTATION ROOM 3121C
- 3131 MEETING ROOM 3131
- 3133 & 3135 STUDENT ORG OFFICES 3133, 3135
- 3136 & 3138 MEETING ROOMS 3136, 3138
- 3204 CLASSROOM 3204
- 3222 ENGINEERING LEARNING SUITE 3222
- 3225 ENGINEERING COMPUTER LAB 3225
- ELEVATORS
- 3238 CULINARY CREATION LAB 3238
- RESTROOMS
- ENTREPRENEURSHIP HUB & CYBIZ LAB 3231, 3233, 3237
- STEM SCHOLARS 3252, 3254

## SECOND FLOOR

2



- STEP-A-TORIUM
- 2102 ENGINEERING COLLABORATIVE LEARNING 2102
- 2106 BPPI SCI-ART 2106
- 2114 PRINTING SERVICES 2114
- 2118 SICTR ADMIN OFFICE 2118
- 2120 OPEN COLLABORATION 2120
- 2206 CLASSROOM 2206
- 2208 CLASSROOM 2221
- ELECTRONICS, TEXTILES & 3D PRINTING SHOP 2222
- ELEVATORS
- RESTROOMS
- 2231 LAS I+E 2231
- 2233, 2235 & 2237 MEETING ROOMS 2233, 2235, 2237
- 2239, 2251 & 2253 STUDENT ORG OFFICES 2239, 2251, 2253
- COURTYARD
- 2260 PROJECT SUITE 2260
- 2261 DIGITAL MODELING & VISUALIZATION LAB 2261

## FIRST FLOOR

1

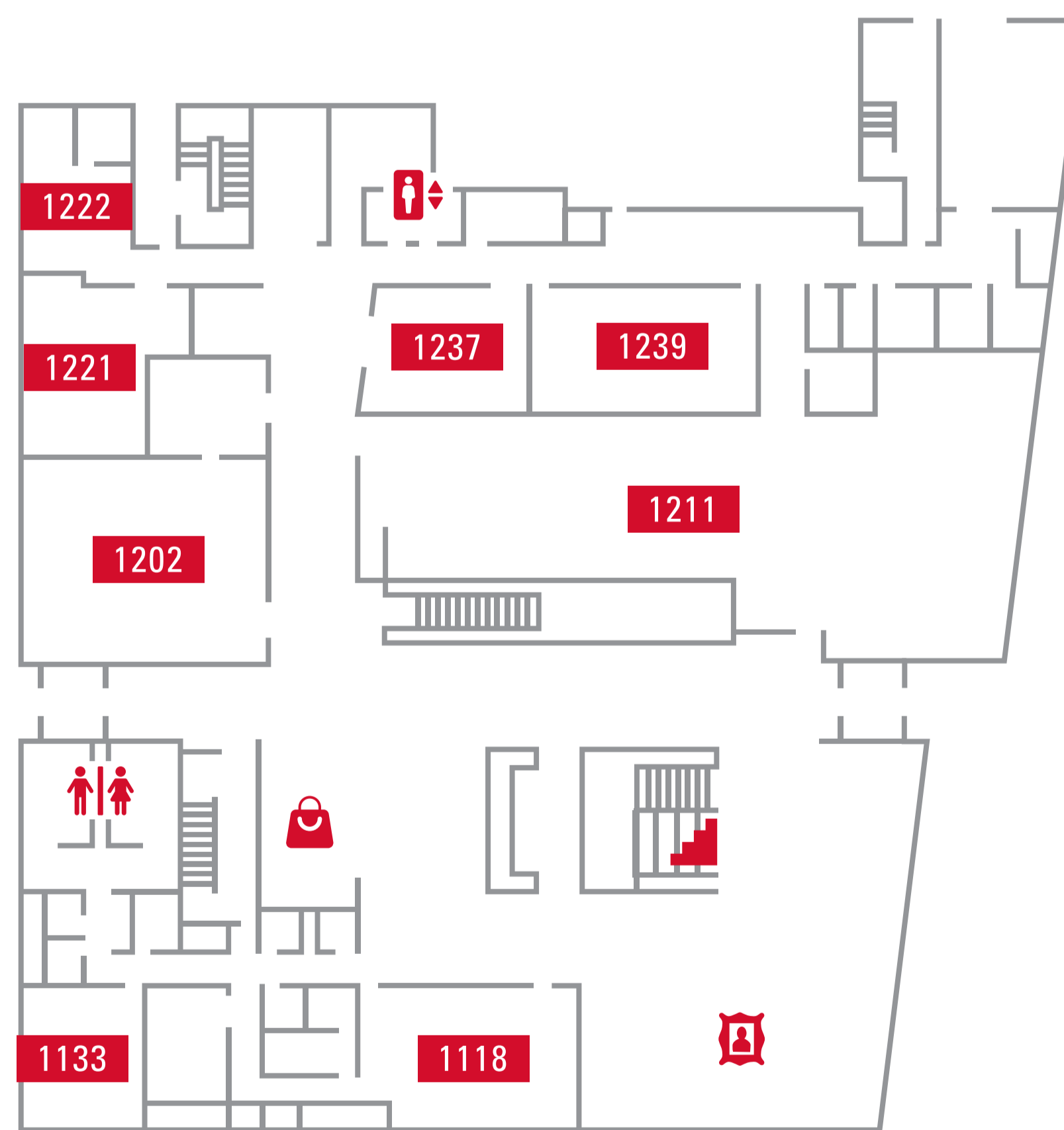

- STEP-A-TORIUM
- EXHIBITS AREA
- 1118 INNOVATION SPACE 1118
- 1133 MEETING ROOM 1133
- RESTROOMS
- INNOVATE 1858
- 1202 GAFFER'S GUILD 1202
- 1221 PAINT & FINISHING SHOP 1221
- 1222 INTERDISCIPLINARY COLLABORATION 1222
- ELEVATORS
- 1237 SUPPLY DEPOT 1237
- 1239 ASSEMBLY BAY 1239
- 1211 METAL & WOOD SHOP 1211

## BASEMENT

B



- 0102 GAME DESIGN LAB 0102
- 0104, 0106 & 0108 STUDENT ORG OFFICES 0104, 0106, 0108
- 0107 MEETING ROOM 0107
- 0114 AUDITORIUM 0114
- 0122 MEETING ROOM 0122
- RESTROOMS
- 0140 - 0142E DIGITAL MEDIA SHOP 0140 - 0142E
- 0212 COMPOSITES SHOP 0212
- ELEVATORS
- 0244 - 0246 DYNO ROOMS 0244, 0246
- 0235 HEAVY METAL SHOP 0235
- 0211 STUDENT ORG ASSEMBLY BAY 0211
- 0254 ENGINEERING ASSEMBLY BAY 0254
- 0256 ARCHITECTURAL ROBOTICS LAB 0256